

# THERMAL SPRAY COMPONENTS

## Tilting Turntable KT90

The basic thermal spray process handling system configuration exists typically of an industrial robot for the manipulation of the gun and a turntable as a work piece handling. The KT90 tilting turntable is especially designed to work in conjunction with the robot. All functions of the turntable are coordinated and controlled by the robot. The turntable has the capability of indexing/positioning, and tilting, controlled as external robot axes (7th and 8th axis). The tilting range is from horizontal to 90° vertical position. This configuration is selected and required for optimal coating of complex parts, such as blades, vanes or liners. In this way, all faces and angles of the parts can be achieved in combination with manipulating the spray gun to ensure optimal coating conditions, such as spray angles and distance, speeds and coating coverage.

Weight	650 kg
Loading weight	max. 250 kg
Tilting	0 ...90 °
Rotation	max. 300 rpm
Rotation servo motor	12 Nm/3000 rpm with brake
Tilting servo motor	5 Nm/3000 rpm
Total power draw	~1.2 kW

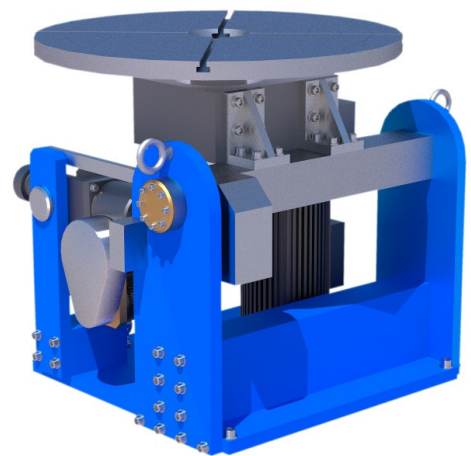

Maximum load is 250kg

- 1 Faceplate
- 2 Chuck (Option)
- 3 Rotational gear
- 4 Rotational motor
- 5 Tilting spindle
- 6 Tilting motor
- 7 Tilting axis
- 8 Chassis

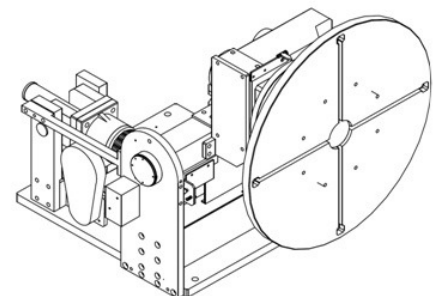
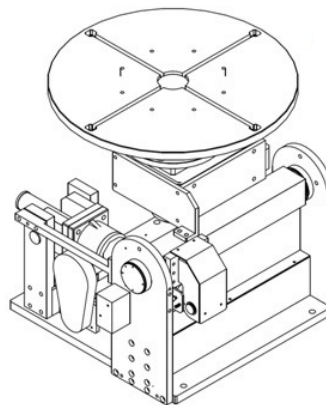
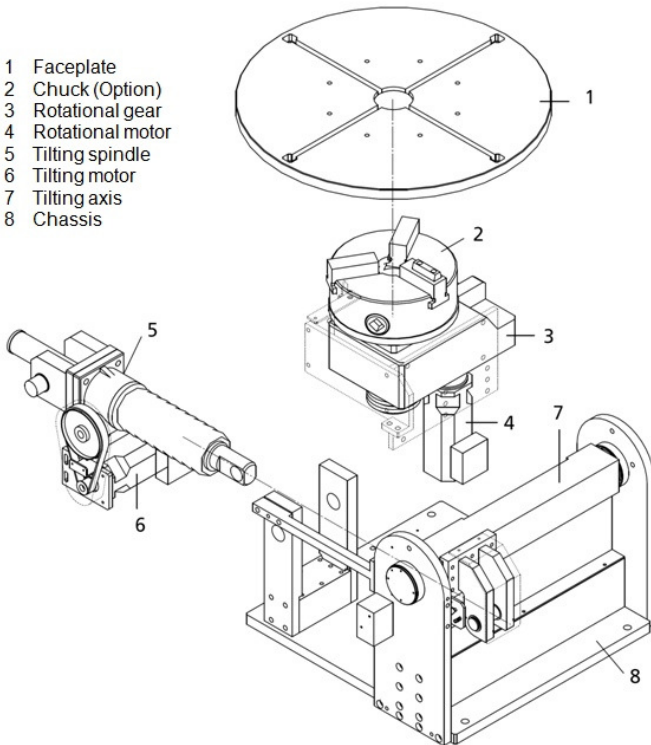

### Switzerland

**AMT AG**  
Badstrasse 34  
CH-5312 Döttingen

Tel.: +41 (0)56 245 9010  
Fax: +41 (0)56 245 9011

### Japan

**Shida International Co. Ltd.**  
4-60-10 Minamidai, Nakano  
164-0014 Tokyo

Tel.: +81 353 42 1377  
Fax: +81 353 42 1378

### Singapore

**AMT AG Ltd.**  
19 Loyang Way 02-04  
Changi Int'l Logistics Center  
Singapore 508724

Tel.: +65 6543 3700  
Fax: +65 6543 3705

### Germany

**KHW Beschichtungstechnik**  
Hamsterweg 10a  
D-65307 Bad Schwalbach

Tel.: +49 (0)6124 7020 962  
Fax: +49 (0)6124 7020 963